

MASONRY WALL PENETRATION

FOR 2", 3", AND 4" PVC CONDUIT
FOR MASONRY BLOCK WALLS

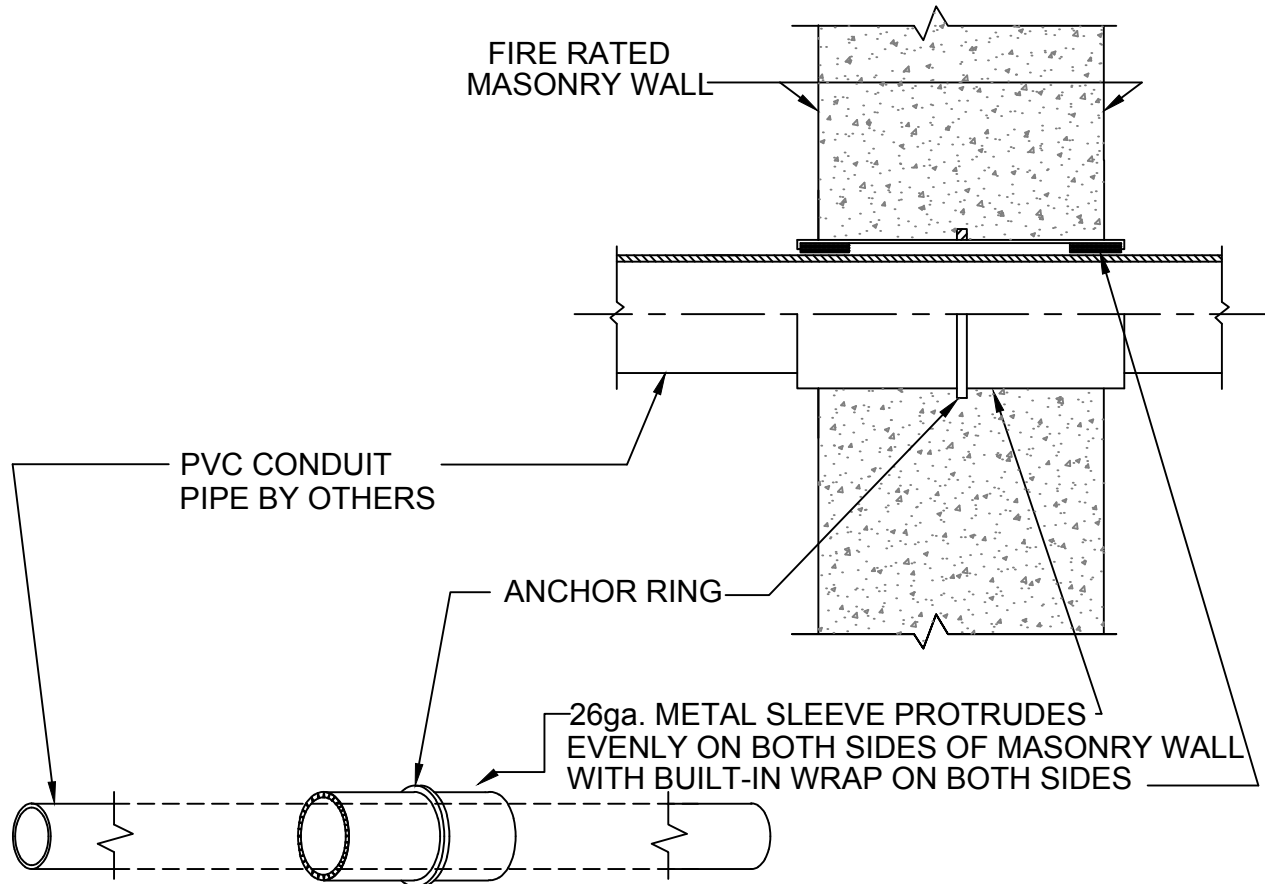

IMPORTANT NOTES :

1. Brick layer to set the sleeve in the desired location and mud the sleeve in to either flush with the face of the wall or centered in the wall.
2. Insert the pass through pipe through the sleeve. Pipe should be supported on both sides of the wall.



W.H. Directory Reference 01 Edition
Firestop Device
W.H. Design No. PS/PHV 180-03
F Rating 3 Hrs.



PROSET[®]
SYSTEMS
FIRESTOP PENETRATOR™

DATE :
12-11-19
DRG . NO .
E-9049-G