

GYPSUM WALL PENETRATION

FOR 2", 3", AND 4" PVC CONDUIT
FOR 2 HR. GYPSUM WALLS

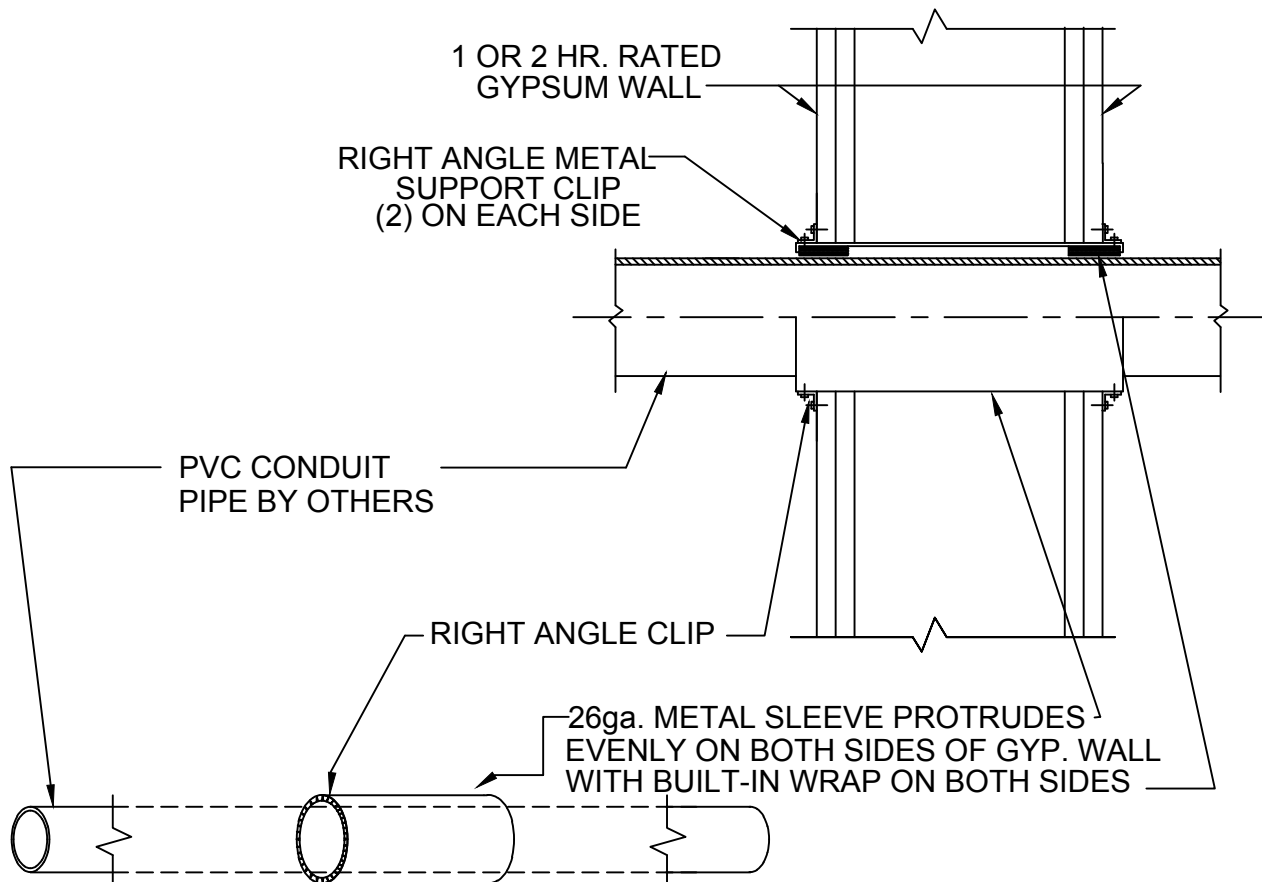

IMPORTANT NOTES :

1. For an existing gyp. wall, drill a 3" hole for 2" pipe, a 4 1/2" hole for 3" pipe & a 6" hole for 4" pipe. For a future wall, install the sleeve around the pipe at the new wall location & fasten clips latter.
2. Fasten right angle clips to the sleeve w/ sheet metal screws and into the gyp. wall w/ plastic anchors.
3. Insert the pass through pipe through the sleeve. Pipe should be supported on both sides of the wall.
4. Use a firestop adhesive type caulking to fill large gaps around the metal sleeve and the gyp. wall. Gaps of 1/4" or less can be filled with gypsum wall cement.



W.H. Directory Reference 01 Edition
Firestop Device
W.H. Design No. PS/PV 120-07
F Rating 2 Hrs.



PROSET[®]
SYSTEMS
FIRESTOP PENETRATOR™

DATE :
12-11-19
DRG . NO .
E-9049-F