

SELF SEAL WALL SLEEVE

FOR POURED CONCRETE WALLS

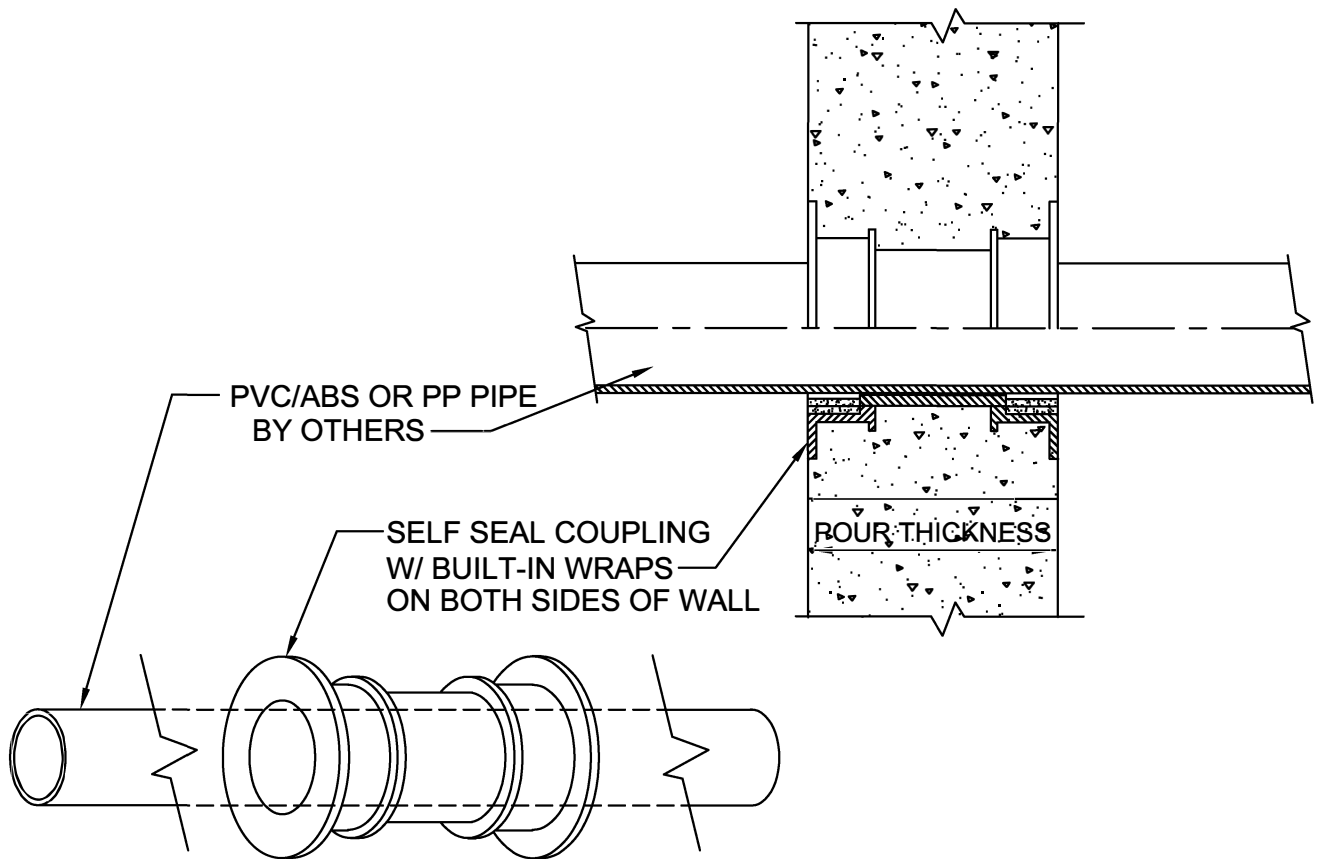

IMPORTANT NOTES :

1. Use nails through flange holes on one side to mount the sleeve coupling to the wall form.
2. The other side will be supported when the opposite form is put in place.
3. After the pour, insert the through pipe from either side of the wall.
4. The pass through pipe can be anchored to the sleeve by using solvent cement around the pipe at the area where the pipe mates up with the sleeve.

Option: Use "Green" lettered coupling pipe when pipe is passing through the sleeve.
 Use "Red" lettered coupling pipe when solvent cementing pipe into sleeve from both sides.



W.H. Directory Reference 00 Edition
 Firestop Device
 W.H. Design No. PS/PHV 180-03
 F Rating 3 Hrs.



PROSET[®]
SYSTEMS
 FIRESTOP PENETRATOR™

DATE :
 5-31-21
 DRG . NO .
 C-9049-PG