

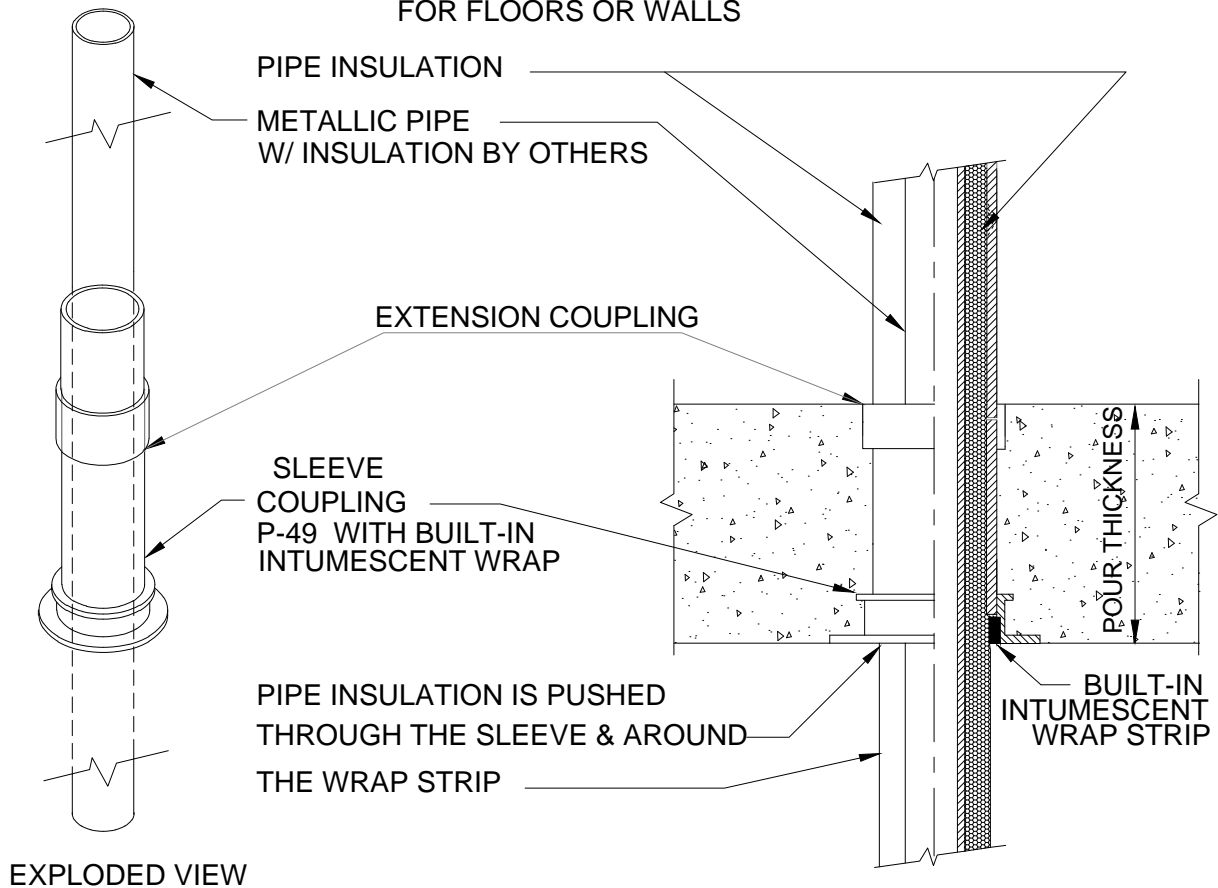

# BUILT-IN WRAP DEVICE FOR INSULATED PIPE

CONCRETE ON WOOD FORM  
FOR FLOORS OR WALLS



## IMPORTANT NOTES :

1. Use nails or screws through flange holes to mount the 49 sleeve coupling with the coupling extension to the wood or metal deck form.
2. After concrete is poured, remove protective cap then solvent cement the extension pipe to the disired height.
3. Insert insulated pass through metallic piping up through the sleeve coupling.  
(The pass through piping should be supported on the top side of the penetration.)
4. A Silicone caulk should be used to fill any void between the pipe insulation and the sleeve.

 W.H. Directory Reference 00 Edition  
 Firestop Device  
 W.H. Design No. PS/PHV 180-03  
 F & T Ratings 3 Hrs



**PROSET**<sup>®</sup>  
**SYSTEMS**  
 FIRESTOP PENETRATOR™

DATE :  
 1-10-06  
 DRG . NO .  
 A-1016-AIC