

# RISER CLAMP DEVICE

PRECAST CONCRETE OR EXISTING CONCRETE  
FOR FLOORS OR WALLS

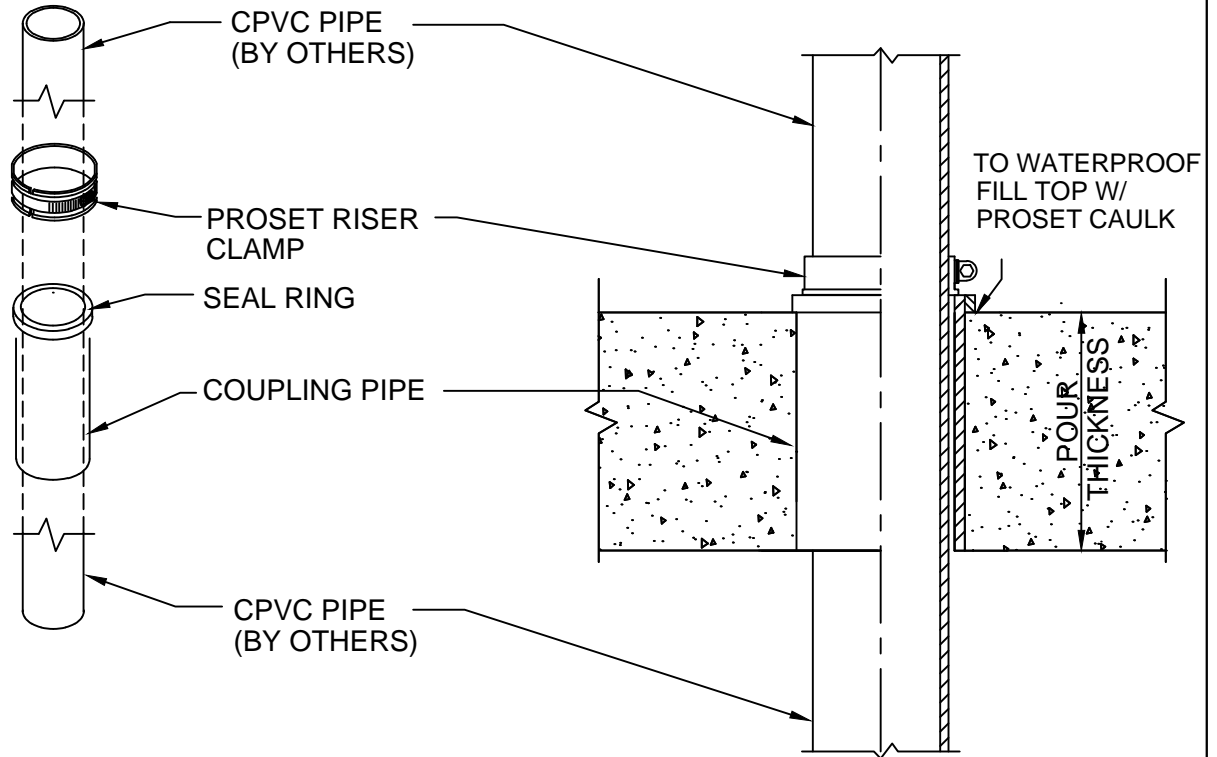

Size	Part No.	Description	Price	Unit Total	Core Size
2"	P2543H-B or G-CH A02214	2" Sleeve Coupling 2" Riser Clamp	4.50 2.95	7.45	2 3/4"
2 1/2"	P3843H-CH A03212	2 1/2" Sleeve Coupling 2 1/2" Riser Clamp	7.35 3.85	11.20	4"
3"	P3543H-B or G-CH A03214	3" Sleeve Coupling 3" Riser Clamp	6.70 3.30	10.00	4"
4"	P4543H-B or G-CH A04214	4" Sleeve Coupling 4" Riser Clamp	9.20 4.15	13.35	5"
5"	P6855H-CH A05214	5" Sleeve Coupling 5" Riser Clamp	23.15 6.60	29.75	7-1/2"
6"	P6543H-B-CH A06214	6" Sleeve Coupling 6" Riser Clamp	15.30 6.75	22.05	7-1/2"

Use "B" Black letter sleeve pipe for cast iron, glass or steel or "G" Green for copper or plastic  
Use suffix CU for copper -CI for cast iron -S for steel pipe when ordering Riser Clamps.



W.H. Directory Reference 97 Edition  
Firestop Device  
W.H. Design No. PS/PHV 120-05  
F Rating 2 Hrs.



**PROSET**<sup>®</sup>  
**SYSTEMS**  
FIRESTOP PENETRATOR™

DATE :  
8-01-18  
DRG . NO .  
A-1015-D