

# RISER CLAMP DEVICE

PRECAST CONCRETE OR EXISTING CONCRETE  
FOR FLOORS OR WALLS

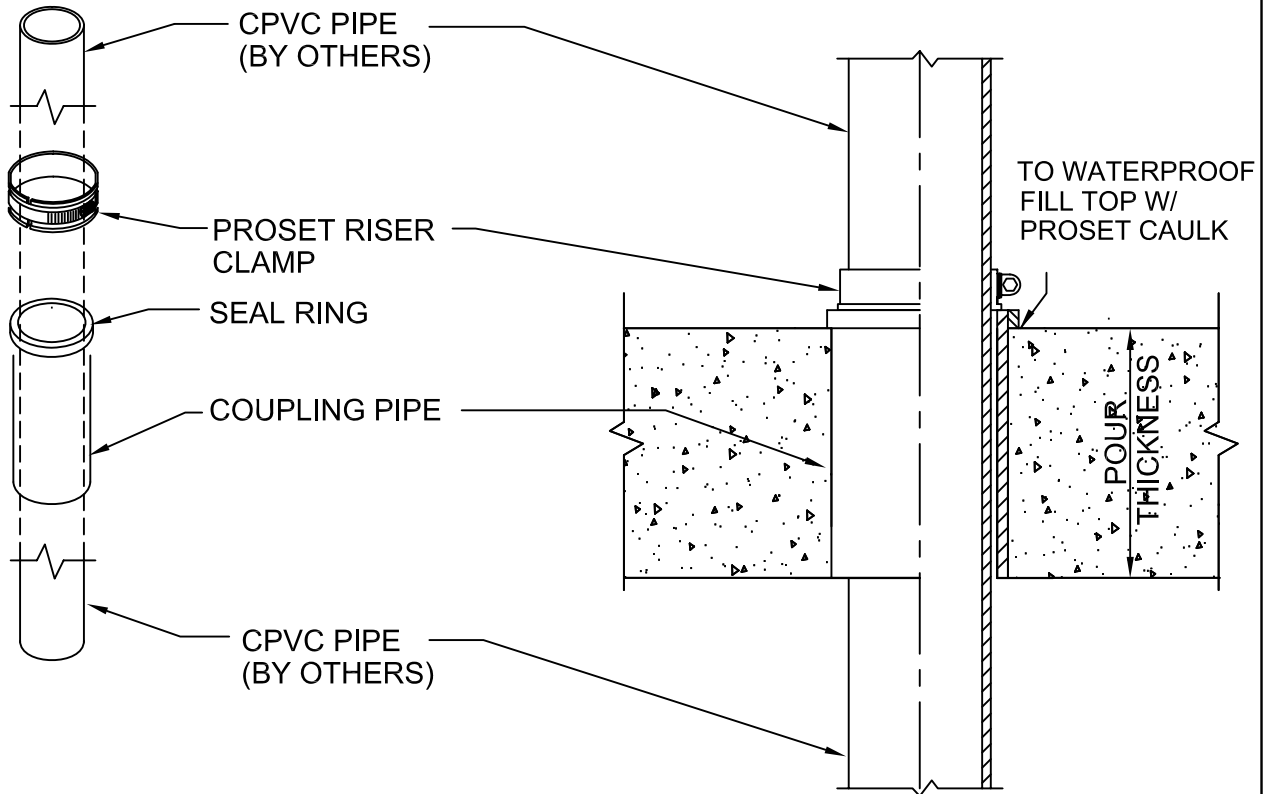

## IMPORTANT NOTES :

1. Core a 2 3/4" hole for 2" - 4" hole for 3" - 5" hole for 4" - 7" for 6".
2. Install a bead of ProSet Caulk around the coupling flange to waterproof.
3. Insert the CPVC pipe through the coupling.
4. Fill void at top with ProSet Caulking to waterproof.
5. Install riser clamp around the pipe to support and draft stop. Clamp on both sides for walls.
6. When ordering riser clamp - Use suffix CU for copper sizes - S for steel pipe sizes.
7. Use Black letter Sleeve Pipe for steel sizes - Red letter pipe for copper sizes.



W.H. Directory Reference 97 Edition  
Firestop Device  
W.H. Design No. PS/PHV 120-05  
F Rating 2 Hrs.



**PROSET**<sup>®</sup>  
**SYSTEMS**  
FIRESTOP PENETRATOR™

DATE :  
1-10-06  
DRG. NO. :  
A-1015-D