

# PROSEAL PLUG DEVICE

CONCRETE ON WOOD FORM  
FOR FLOORS OR WALLS

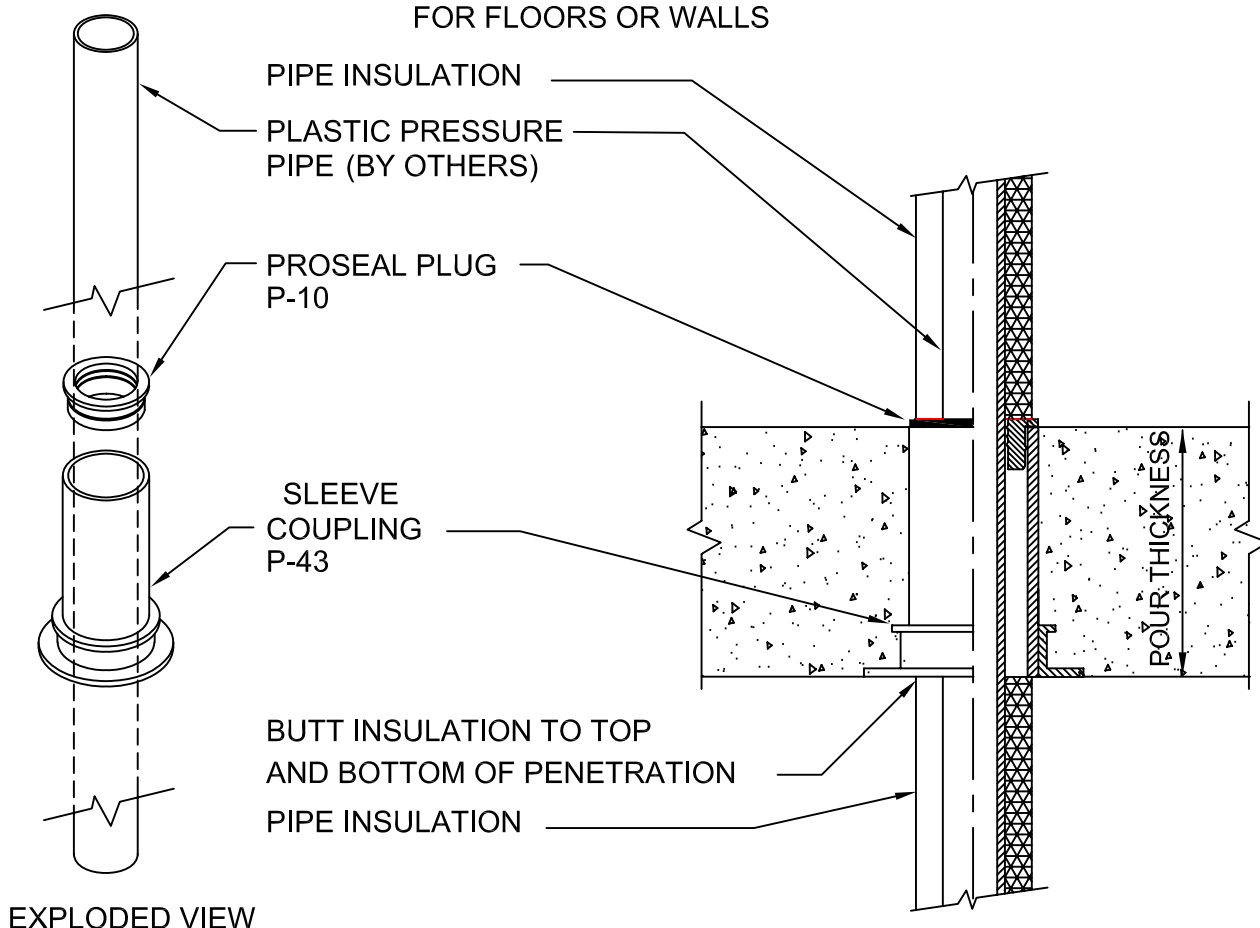

EXPLODED VIEW

## IMPORTANT NOTES :

1. Use nails through flange holes to mount the sleeve coupling to the deck.
2. After concrete is poured, remove protective cap.
3. Insert pass through piping up through the sleeve coupling.
4. Install the proper size split ProSeal Plug around the pipe & drive in from the top side.
5. Use two ProSeal plugs for wall installation.
6. Insulation is butted up against the top plug and the bottom of sleeve except for chilled water. See drawing A-1000- A or A-1016-ai for chilled water insulation.

Alternate : Plugs may be solvent cemented in for waterproofing and ease of installation.



W.H. Directory Reference 99 Edition  
Firestop Device  
W.H. Design No. PS/PHV 120-03  
F Rating 2 Hrs.or 3 Hrs or 4 Hrs



**PROSET**<sup>®</sup>  
**SYSTEMS**  
FIRESTOP PENETRATOR™

DATE :  
1-10-06

DRG . NO .  
A-1011-ai