

SELF SEAL WALL SLEEVE

FOR 1 OR 2 HR. GYPSUM WALLS

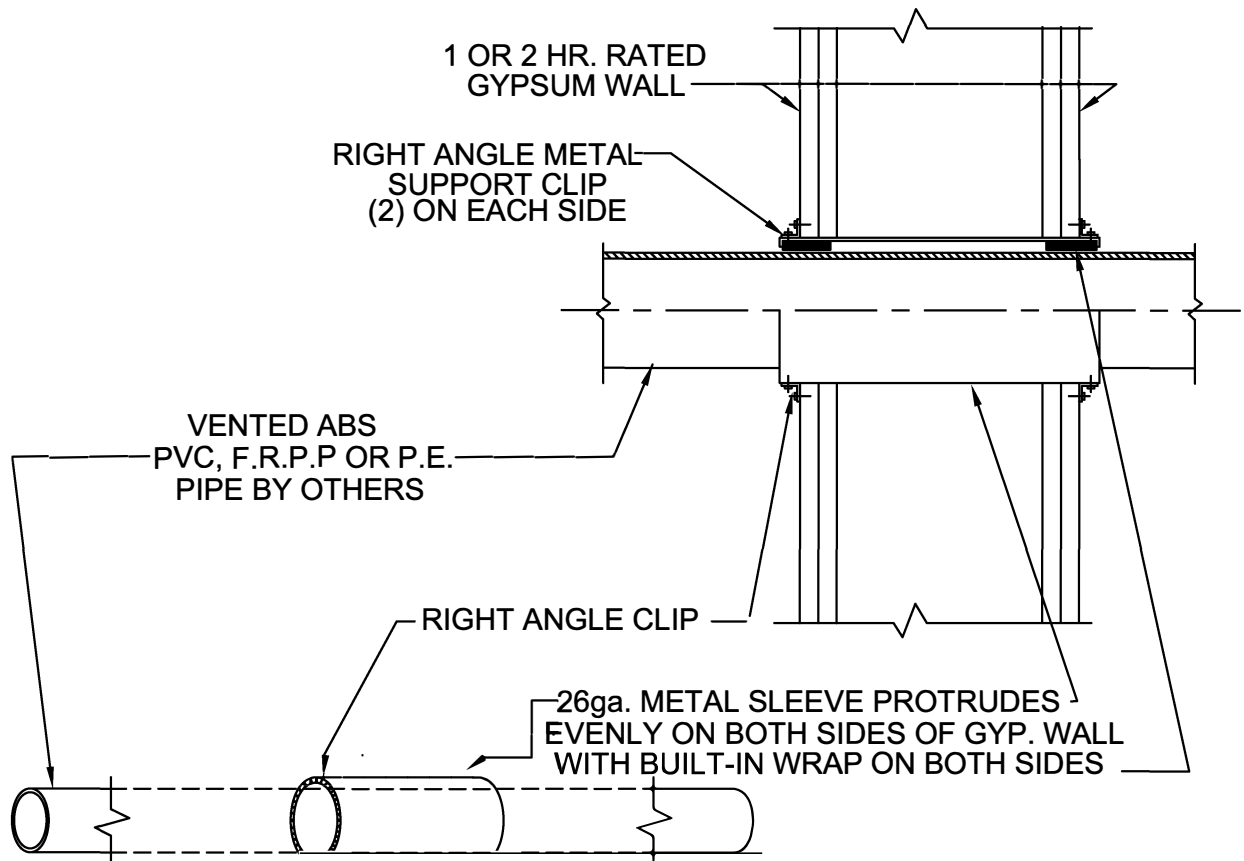

IMPORTANT NOTES :

1. For an existing gyp. wall, drill a 3" hole for 2" pipe, a 4 1/2" hole for 3" pipe & a 6" hole for 4" pipe. For a future wall, install the sleeve around the pipe at the new wall location & fasten clips latter.
2. Fasten right angle clips to the sleeve w/ sheet metal screws and into the gyp. wall w/ plastic amchors.
3. Insert the pass through pipe through the sleeve. Pipe should be supported on both sides of the wall.
4. Use a firestop adhesive type caulking to fill large gaps around the metal sleeve and the gyp. wall. Gaps of 1/4" or less can be filled with gypsum wall cement.

NOTE: This firestop device can also be used through a masonry block wall.
(See Warnock Hersey Design No. PS/PHV 180-03)

NOTE: See drawing A-1013-F for installation for PVC/CPVC pressure pipe.



W.H. Directory Reference 01 Edition
Firestop Device
W.H. Design No. PS/PV 120-07
F Rating 2 Hrs.



PROSET[®]
SYSTEMS
FIRESTOP PENETRATOR™

DATE :

5-31-21

DRG . NO .

C-9049-F