

# Self Seal Stack Assembly

CONCRETE ON CORRUGATED METAL DECK  
FOR FLOORS

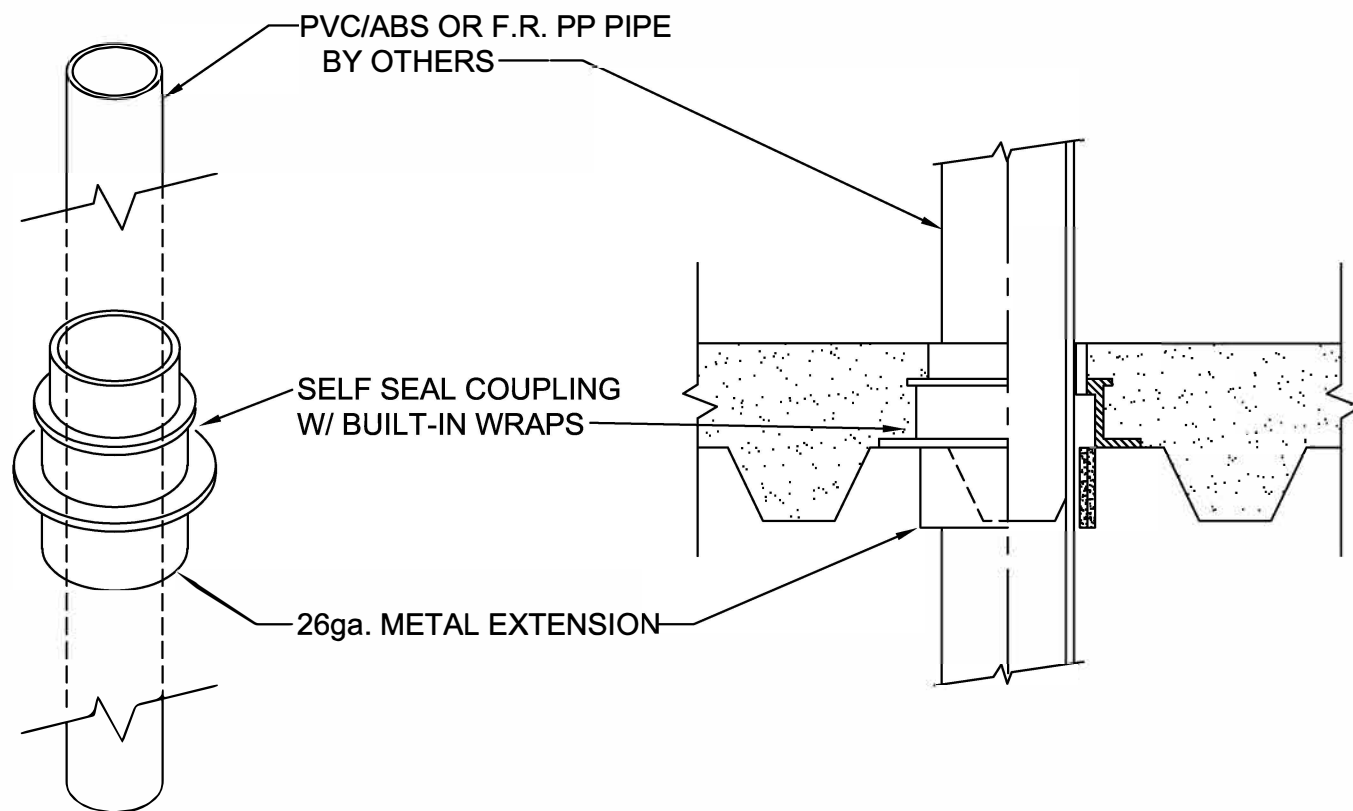

## IMPORTANT NOTES:

1. Cut hole through the corrugated metal deck to accommodate the 26 gauge metal extension to the bottom of the corrugations.
2. Mount the # 49 flange to the corrugated metal with sheet metal screws. If necessary use a right angle metal strip, S-34348, to span the corrugations.
3. After the pour, remove protective cap.
4. Pass the plastic pipe through the green lettered sleeve coupling or solvent cement pipe into the tapered red coupling.
5. If the pass through type sleeve coupling is used, a ProSet Riser Clamp can be used or the pipe can be solvent cemented to the top of the sleeve coupling.



W.H. Directory Reference 99 Edition  
Firestop Device  
W.H. Design No. PS/PH 120-14  
F Rating 2 Hrs.



**PROSET**<sup>®</sup>  
**SYSTEMS**  
FIRESTOP PENETRATOR™

DATE :  
5-31-21

DRG . NO .  
C-9049-C