

# TRAP GUARD XH CAST IRON FLOOR DRAIN

POURED CONCRETE ON GROUND FLOOR

UNDERGROUND FLOOR DRAIN  
PLASTIC OR CAST IRON CONNECTION

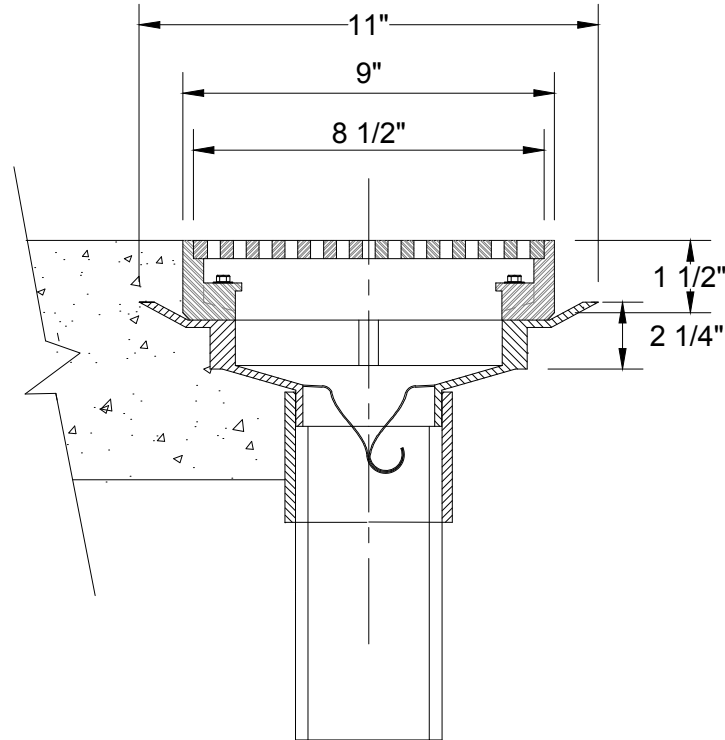

- 9" DIA. MEDIUM DUTY CAST IRON GRATE TOP - (3") T3565X-F-P (4") T4565X-F-P
- USE PROSET E-Z FLEX COUPLING CONNECTION FOR CAST IRON PIPING  
FOR CAST IRON PIPE CONNECTION ADD CI IN PLACE ON P IN ABOVE PART NUMBERS

## IMPORTANT NOTES :

1. The Trap Guard Device is an integral part of the ProSet Floor Drain and comes as a complete unit.
2. The installation is identical to any typical floor drain assembly connecting to plastic or C.I. pipe.
3. Use duct tape to seal up the cast iron strainer to protect against the concrete pour.
4. A factory installed elastomeric plug protects the Trap Guard Device during construction and can be used as a test plug and must be removed before normal drain usage.

If the trap guard device should get damaged or impaired in any way, the device can be easily removed. A puller tool attaches to the two built-in lugs inside of the Trap Guard for easy removal & replacement.

Note: Do not touch the Trap Guard Device with the primer. Not for use on waxed or grease-laden floors.

## MAINTENANCE INSTRUCTIONS:

The Trap Guard device should be inspected periodically for build up of any type debris. The device should then be flushed out thoroughly with clear warm water.



NO FIRE RATINGS ARE  
REQUIRED FOR UNDERGROUND  
PIPING OR OPENINGS



**PROSET**<sup>®</sup>  
**SYSTEMS**  
FIRESTOP PENETRATOR™

DATE :  
5-31-21  
DRG . NO .  
C6331-CITG